



Colchester
Archaeological
Trust

ARCHAEOLOGICAL MONITORING REPORT

CAT Report 1357	Parish: Fordham
Land adjacent to 6 Heath Cottages Fordham Heath	Planning reference: 181341
	CHER Event no.: ECC4258
	OASIS ref.: colchest3-327129
Address: Land adjacent to 6 Heath Cottages Heath Road Fordham Heath Essex CO3 9TN	Grid Reference: TL 93884 26455
	Number of site visits: 3
	Dates of visits: 10th, 12th and 13th December 2018
Nature of the work: Observation of groundworks for the construction of three camping pods	
Reason for condition: The site lies to the east of the historic Fordham Heath, cropmarks are located to the north and south, and a Neolithic polished axe was found some 600m to the southeast.	
% of total seen: 100% of the groundworks.	
Results: The excavation of electrical, water and drainage runs were archaeologically monitored in response to a Brief set by Jess Tipper of Colchester Borough Council Planning Services. A CAT archaeologist supervised the following groundworks: a) 60m of trenching for water mains, 0.4m wide and 0.9m deep; b) 40m of trenching for electrical services, 0.4m wide and 0.45m deep; c) 70m of trenching for drainage runs, 0.4m wide and 0.3-1.2m deep; d) pad bases for the three camping pods, 0.15-0.3m deep; e) an access road; e) an electrical junction box.	
	
Photograph 1 Site shot	

Groundworks penetrated three layers. Modern topsoil (L1, c 0.18-0.28m thick, firm, moist dark grey/brown silty-clay) sealed subsoil (L2, c 0.21-0.23m thick, firm, moist medium grey/brown silty-clay), beneath which lay natural (L3, firm, moist medium orange clay, encountered at a depth of 0.41-0.5m below current ground level).

No significant archaeological remains were encountered, although several 19th- or 20th-century field drains were observed cut into L2.

Recorded by: Dr Elliott Hicks

Date: 14th December 2018



Colchester Archaeological Trust

Roman Circus House,
Roman Circus Walk,
Colchester,
Essex, CO2 7GZ

tel.: 01206 501785

email: eh2@catuk.org

Checked by: Philip Crummy

Date: 14.12.2018

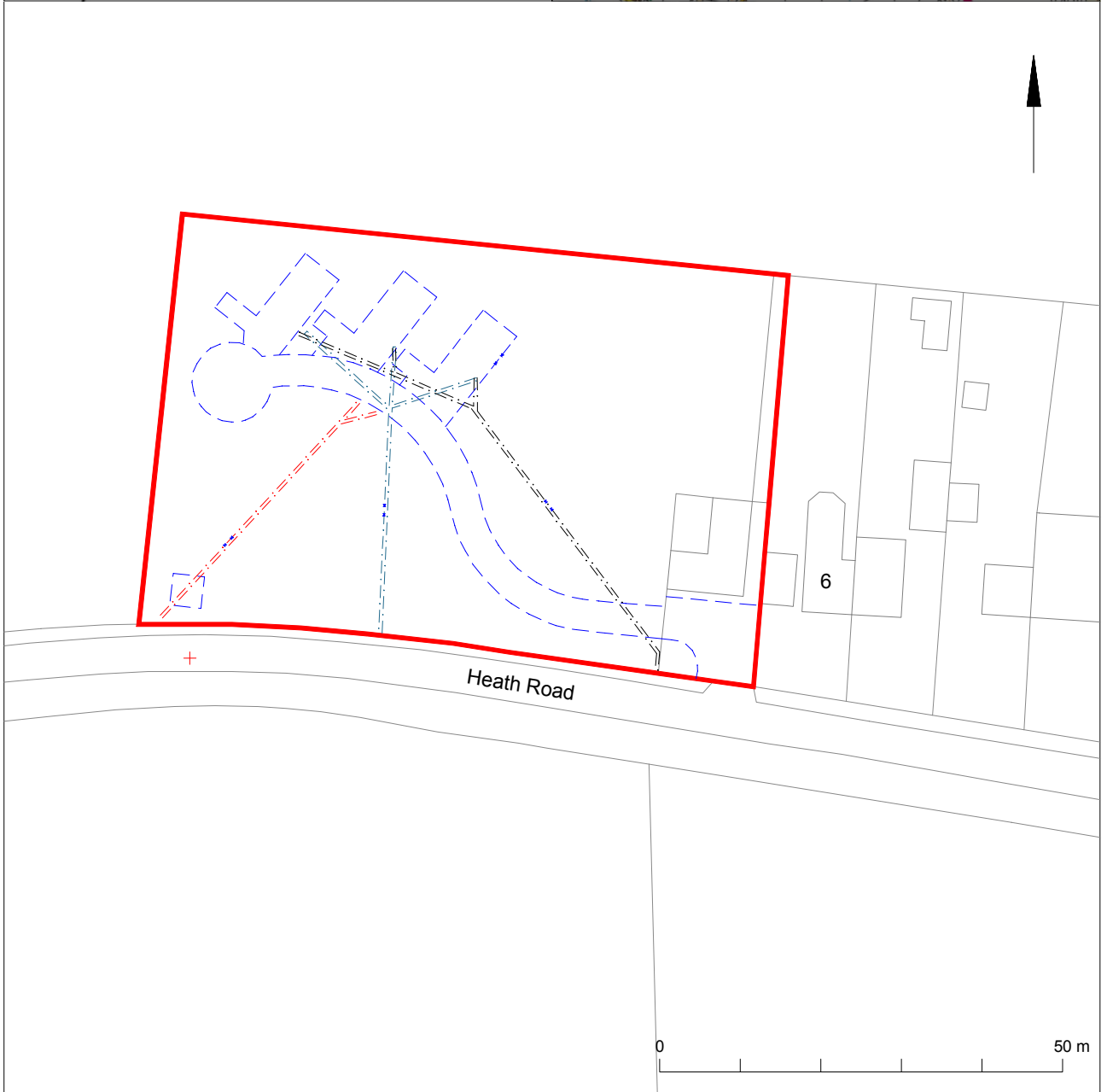
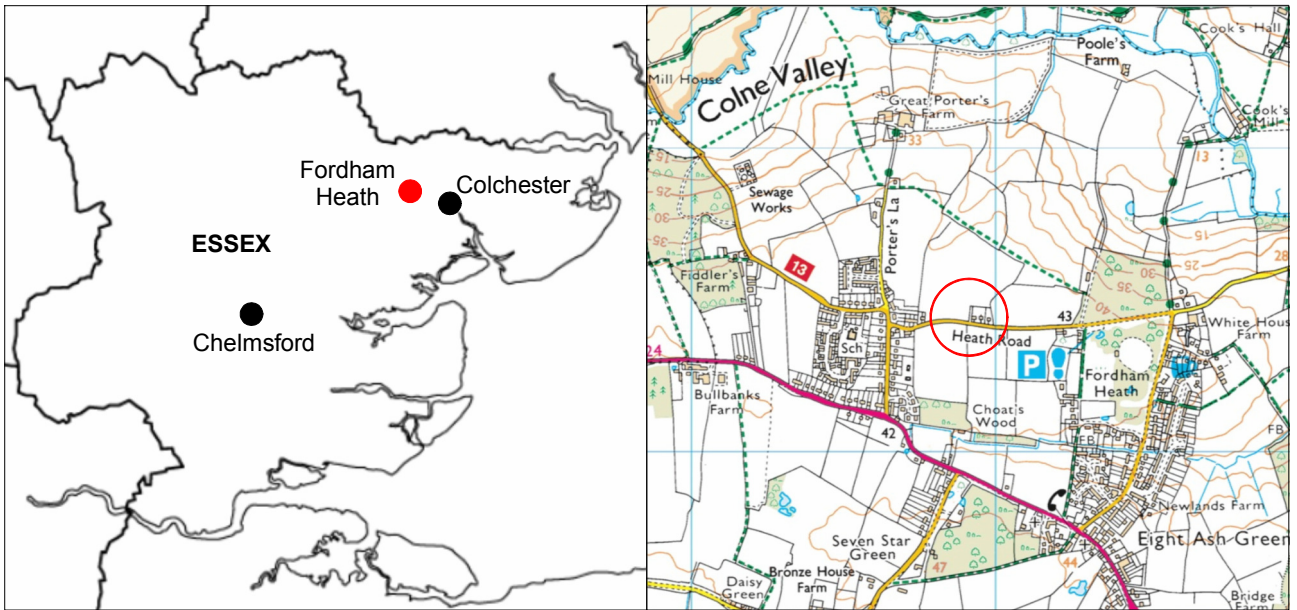

© Crown copyright. All rights reserved. Licence number 100039294.

Fig 1 Site location with proposed development shown in blue.

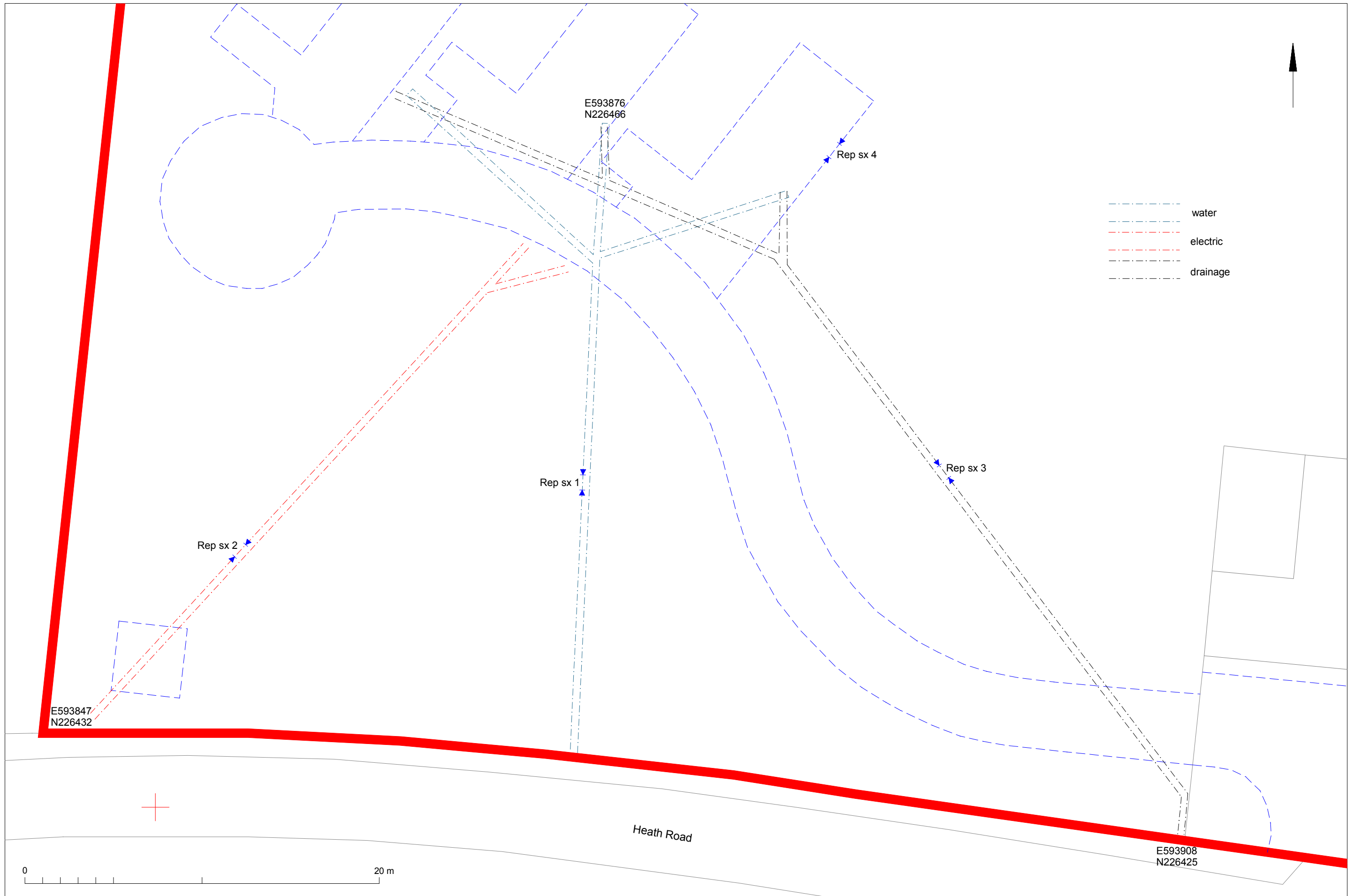

Fig 2 Monitoring results.

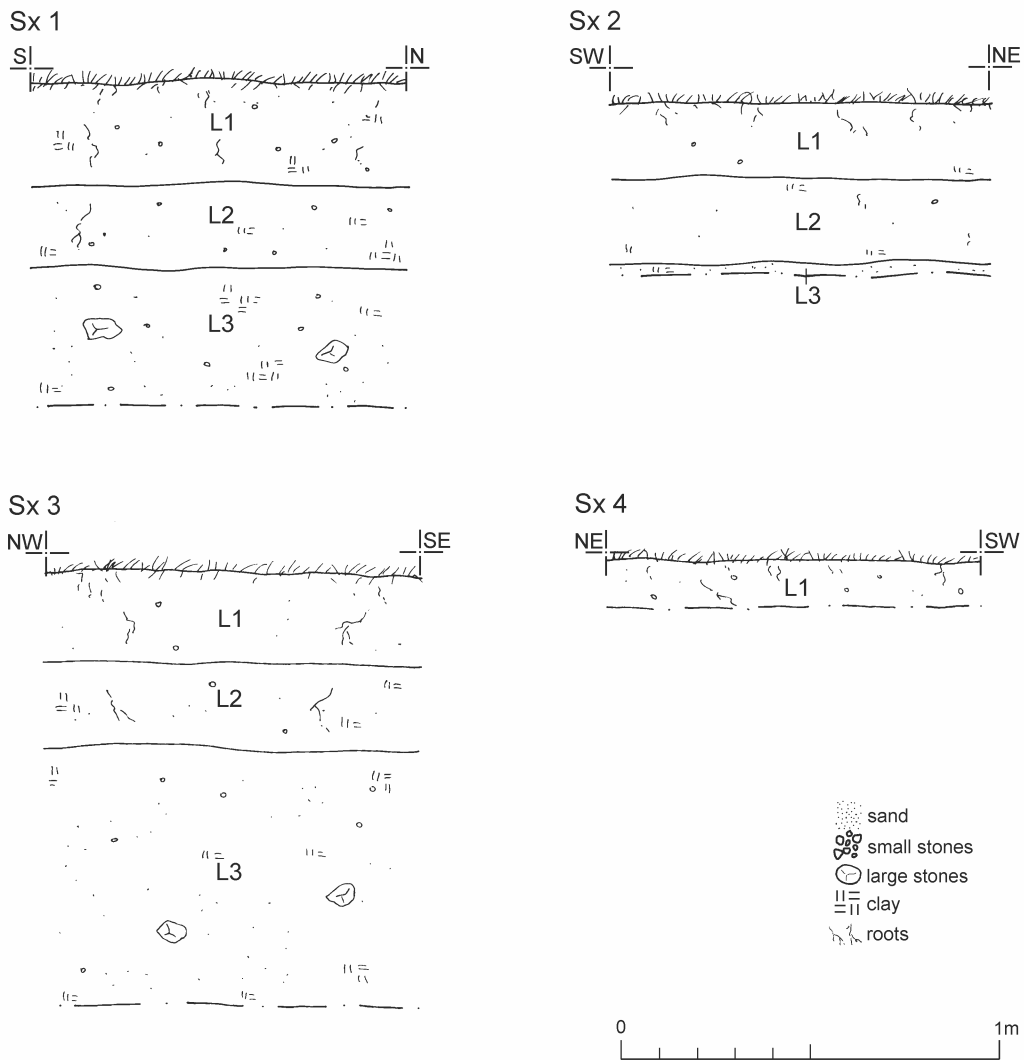

Fig 3 Representative sections.

Written Scheme of Investigation (WSI) for continuous archaeological monitoring and recording at 6 Heath Cottages, Heath Road, Fordham Heath, CO3 9TN

NGR: TL 93884 26455

Planning references: 181341

Client: Mr & Mrs J C Warren

Curating museum: Colchester

Museum accession code: 2018.75

CHER event number: MCC4258

CAT project code: 18/08h

OASIS project number: colchest3-327129

Site manager: Chris Lister

CBC monitor: Jess Tipper

This WSI written: 31.8.2018

revised: 3.9.2018

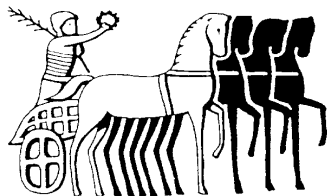

COLCHESTER ARCHAEOLOGICAL TRUST,
Roman Circus House,
Roman Circus Walk,
Colchester,
Essex, CO2 7GZ

tel: 01206 501785

email: lp@catuk.org

Site location and description

The proposed development site is located on land adjacent to 6 Heath Cottages, Heath Road, Fordham Heath, 6km WNW of Colchester town centre (Fig 1). Site centre is NGR TL 93884 26455.

Proposed work

The development proposes change of land use to a glamping site with the construction of three glamping pods and associated groundworks.

Archaeological background

The following archaeological background draws on the major published sources for Colchester archaeology, and also on the Colchester Historic Environment Record (CHER) accessed via the Colchester Heritage Explorer (www.colchesterheritage.co.uk).

The development site is located within an area of archaeological interest. Fordham Heath, an area of historic heathland shown on the Chapman and André map of 1777, is located to the east of the site (CHER MCC9171). Surrounding the site a number of cropmarks have also been identified including rectilinear enclosures and associated trackways to the north (MCC7723) and linears and pits to the south (MCC7777). Approximately 600m to the south-east a Neolithic polished axe (MCC7585) axe was found.

Planning background

A planning application was made to Colchester Borough Council in May 2018 (application no. 181341) for change of use of land to a glamping site.

As the site lies within an area highlighted by the CHER as having a high potential for archaeological deposits, an archaeological condition was recommended by the Colchester Borough Council Archaeological Advisor (CBCAA). The recommended archaeological condition is based on the guidance given in the *National Planning Policy Framework* (MHCLG 2018).

Requirement for work

The required archaeological work is for continuous archaeological monitoring and recording of all groundworks for the concrete bases of the glamping pods, new access road and services. Details are given in a Project Brief written by CBCAA (CBCPS 2018).

Specifically:

The monitoring and recording is being undertaken to identify and record any surviving archaeological deposits that may exist on site.

If unexpected remains are encountered the CBCAA will be informed immediately and the CBCAA will decide if amendments to the brief are required to ensure adequate provision for archaeological recording.

General methodology

All work carried out by CAT will be in accordance with:

- professional standards of the Chartered Institute for Archaeologists, including its *Code of Conduct* (CIfA 2014a, b)
- Standards and Frameworks published by East Anglian Archaeology (Gurney 2003, Medlycott 2011)
- relevant Health & Safety guidelines and requirements (CAT 2018)
- the Project Brief issued by the CBCAA (CBC 2018).

Professional CAT field archaeologists will undertake all specified archaeological work, for which they will be suitably experienced and qualified.

Notification of the supervisor/project manager's name and the start date for the project will be provided to CBCAA one week before start of work.

Unless it is the responsibility of other site contractors, CAT will study mains service locations and avoid damage to these.

At the start of work (immediately before fieldwork commences) an OASIS online record <http://ads.ahds.ac.uk/project/oasis/> will be initiated and key fields completed on Details, Location and Creators forms. At the end of the project all parts of the OASIS online form will be completed for submission to EHER. This will include an uploaded .PDF version of the entire report.

A project or site code will be sought from the curating museum. This code will be used to identify the project archive when it is deposited at the curating museum.

Staffing

The number of field staff for this project is estimated as follows: One CAT officer for the duration of the groundworks.

Monitoring methodology

There will be sufficient on-site attendance by CAT staff to maintain a watch on all contractors' ground works to record, excavate or sample (as necessary) any archaeological features or deposits.

All topsoil removal and ground reduction will be done with a toothless bucket.

If archaeological features or deposits are uncovered, time will be allowed for these to be planned and recorded.

If any features or deposits uncovered are to be destroyed by the proposed development, time will be allowed for these features to be excavated by hand. This includes a 50% sample of discrete features (pits, etc) and 10% of linear features (ditches, etc).

Fast hand-excavation techniques involving (for instance) picks, forks and mattocks will not be used on complex stratigraphy.

Individual records of excavated contexts, layers, features or deposits will be entered on pro-forma record sheets. Registers will be compiled of finds, small finds and soil samples.

All features and layers or other significant deposits will be planned, and their profiles or sections recorded. The normal scale will be site plans at 1:20 and sections at 1:10, unless circumstances indicate that other scales would be appropriate.

Site surveying

Normal scale for archaeological site plans and sections is 1:20 and 1:10 respectively, unless circumstances indicate that other scales would be more appropriate.

The site grid will be tied into the National Grid. Corners of excavation areas and trenches will be located by NGR coordinates.

Environmental sampling policy

CAT has an arrangement with Val Fryer/Lisa Gray whereby any potentially rich environmental layers or features will be appropriately sampled as a matter of course, but only if they are datable. A contingency for radiocarbon dating will be made in case any significant environmental deposits are identified. Any processing and reporting will be done by VF/LG. If any complex or outstanding deposits are encountered, VF/LG will be asked onto site to advise. EH Regional Adviser is available for further advice.

Human remains

CAT follows the policy of leaving human remains *in situ* unless there is a clear indication that the remains are in danger of being compromised as a result of their exposure. If circumstances indicated it were prudent or necessary to remove remains from the site during the monitoring, the following criteria would be applied; if it is clear from their position, context, depth, or other factors that the remains are ancient, then normal procedure is to apply to the Department of Justice for a licence to remove them. In that case, conditions laid down by the license will be followed. If it seems that the remains are not ancient, then the coroner, the client, and CBCAA will be informed, and any advice and/or instruction from the coroner will be followed.

Photographic record

Will include both general and feature-specific photographs, the latter with scale and north arrow. A photo register giving context number, details, and direction of shot will be prepared on site, and included in the site archive.

Finds

All significant finds will be retained.

All finds, where appropriate, will be washed and marked with site code and context number.

Most of our finds reports are written internally by CAT Staff under the supervision and direction of Philip Crummy (Director) and Howard Brooks (Deputy Director). This includes specialist subjects such as:

prehistoric and Roman pottery: Matthew Loughton

post-Roman pottery: Howard Brooks

animal bones (small groups): Alec Wade / Adam Wightman

small finds, metalwork, coins, etc: Laura Pooley

flints: Adam Wightman

environmental processing: Robin Mathieson

or to outside specialists:

animal bones (large groups) and human remains: Julie Curl (*Sylvanus*)

environmental assessment and analysis: Val Fryer / Lisa Gray

conservation/x-ray: Laura Ratcliffe (LR Conservation) /

Norfolk Museums Service, Conservation and Design Services

Other specialists whose opinion can be sought on large or complex groups include:

prehistoric and Roman pottery: Stephen Benfield

Roman brick/tile: Ernest Black

Roman glass: Hilary Cool

Prehistoric pottery: Paul Sealey

Other: EH Regional Adviser in Archaeological Science (East of England).

All finds of potential treasure will be removed to a safe place, and the coroner informed immediately, in accordance with the rules of the Treasure Act 1996. The definition of treasure is given in pages 3-5 of the Code of Practice of the above act. This refers primarily to gold or silver objects.

Requirements for conservation and storage of finds will be agreed with the appropriate museum prior to the start of work, and confirmed to CBCAA.

Results

Notification will be given to CBCAA when the fieldwork has been completed.

An appropriate archive will be prepared to minimum acceptable standards outlined in *Management of Research Projects in the Historic Environment* (English Heritage 2006).

The report will be submitted within 6 months of the end of fieldwork, with a copy supplied to CBCAA as a PDF.

The report will contain:

- Location plan of the groundworks in relation to the proposed development. At least two corners of the site will be given 10 figure grid references.
- Section/s drawings showing depth of deposits from present ground level with Ordnance Datum, vertical and horizontal scale.
- Archaeological methodology and detailed results including a suitable conclusion and discussion and results referring to Regional Research Frameworks (Medlycott 2011).
- All specialist reports or assessments
- A concise non-technical summary of the project results.

An EHER summary sheet will also be completed within four weeks and supplied to CBCAA.

Results will be published, to at least a summary level (i.e. round-up in *Essex Archaeology & History*) in the year following the archaeological field work. An allowance will be made in the project costs for the report to be published in an adequately peer-reviewed journal or monograph series

Archive deposition

It is a policy of Colchester Borough Council that the integrity of the site archive be maintained (i.e. all finds and records should be properly curated by a single organisation), with the archive available for public consultation. To achieve this desired aim it is assumed that the full archive will be deposited in Colchester Museums *unless otherwise agreed in advance*. (A full copy of the archive shall in any case be deposited).

By accepting this WSI, the client agrees to deposit the archive, including all artefacts, at Colchester & Ipswich Museum.

The requirements for archive storage will be agreed with the curating museum.

If the finds are to remain with the landowner, a full copy of the archive will be housed with the curating museum.

The archive will be deposited with Colchester & Ipswich Museum within 3 months of the completion of the final publication report, with a summary of the contents of the archive supplied to CBCAA.

Monitoring

CBCAA will be responsible for monitoring progress and standards throughout the project, and will be kept regularly informed during fieldwork, post-excavation and publication stages.

Notification of the start of work will be given to CBCAA one week in advance of its commencement.

Any variations in this WSI will be agreed with CBCAA prior to them being carried out.

CBCAA will be notified when the fieldwork is complete.

The involvement of CBCAA shall be acknowledged in any report or publication generated by this project.

References

- | | | |
|------------------|-------|-------------------------------------------------------------------------------------------------------------------------------------------------|
| Brown, D | 2007 | <i>Archaeological Archives: A guide to best practice in creation, compilation, transfer and curation</i> |
| CAT | 2018 | <i>Health & Safety Policy</i> |
| CBCPS | 2018 | <i>Brief for Continuous Archaeological Monitoring and Recording at 6 Heath Cottages, Heath Road, Fordham Heath CO3 9TN</i> |
| CifA | 2014a | <i>Standard and Guidance for an archaeological watching brief</i> |
| CifA | 2014b | <i>Standard and guidance for the creation, compilation, transfer and deposition of archaeological archives</i> |
| CifA | 2014c | <i>Standard and guidance for the collection, documentation, conservation and research of archaeological materials</i> |
| English Heritage | 2006 | <i>Management of Research Projects in the Historic Environment (MoRPHE)</i> |
| Gurney, D | 2003 | <i>Standards for field archaeology in the East of England</i> . East Anglian Archaeology Occasional Papers 14 (EAA 14). |
| Medlycott, M | 2011 | <i>Research and archaeology revisited: A revised framework for the East of England</i> . East Anglian Archaeology Occasional Papers 24 (EAA 24) |
| MHCLG | 2012 | <i>National Planning Policy Framework</i> . Ministry of Housing, Communities and Local Government. |

S Carter



Colchester Archaeological Trust
Roman Circus House,
Roman Circus Walk,
Colchester,
Essex,
CO2 2GZ

tel: 01206 501785
email: lp@catuk.org

OASIS DATA COLLECTION FORM: England

[List of Projects](#) | [Manage Projects](#) | [Search Projects](#) | [New project](#) | [Change your details](#) | [HER coverage](#) | [Change country](#) | [Log out](#)

Printable version

OASIS ID: colchest3-327129

Project details

Project name	Archaeological Monitoring and Recording on Land Adjacent to 6 Heath Cottages, Heath Road, Fordham Heath
Short description of the project	Archaeological monitoring was carried out on land adjacent to 6 Heath Cottages, Fordham Heath, during groundworks for three camping pods. The development site is located east of the historic Fordham Heath, in the midst of a number of cropmarks, and the findspot of a Neolithic polished axe. No significant archaeological features were uncovered.
Project dates	Start: 10-12-2018 End: 13-12-2018
Any associated project reference codes	18/08h - Contracting Unit No.
Any associated project reference codes	COLEM: 2018.75 - Museum accession ID
Any associated project reference codes	ECC4258 - HER event no.
Type of project	Recording project
Investigation type	""Watching Brief""

Project location

Country	England
Site location	ESSEX COLCHESTER FORDHAM 6 Heath Cottages
Postcode	CO3 9TN
Study area	0.4 Hectares
Site coordinates	TL 93884 26455 51.9023350163 0.81863582285 51 54 08 N 000 49 07 E Point

Project creators

Name of Organisation	Colchester Archaeological Trust
	CBC Archaeological Officer

Project brief originator	
Project design originator	Sarah Carter
Project director/manager	Chris Lister
Project supervisor	Ben Holloway
Type of sponsor/funding body	Developer

Project archives

Physical Archive Exists?	No
Digital Archive recipient	Colchester Museum
Digital Archive ID	COLEM: 2018.75
Digital Media available	"Images raster / digital photography", "Text"
Paper Archive recipient	Colchester Museum
Paper Archive ID	COLEM: 2018.75
Paper Media available	"Context sheet", "Drawing", "Photograph", "Report"

Project bibliography 1

Publication type	Grey literature (unpublished document/manuscript)
Title	Archaeological monitoring on land adjacent to 6 Heath Cottages, Fordham Heath, Essex, CO3 9TN: December 2018
Author(s)/Editor(s)	Hicks, E.
Other bibliographic details	CAT Report 1357
Date	2018
Issuer or publisher	Colchester Archaeological Trust
Place of issue or publication	Colchester
Description	A4 loose-leaf ringbound
URL	http://cat.essex.ac.uk/
Entered by	Elliott Hicks (eh2@catuk.org)
Entered on	17 December 2018

OASIS:

Please e-mail [Historic England](#) for OASIS help and advice
© ADS 1996-2012 Created by [Jo Gilham and Jen Mitcham, email](#) Last modified Wednesday 9 May 2012
Cite only: <http://www.oasis.ac.uk/form/print.cfm?id=337045> for this page

[Cookies](#) [Privacy Policy](#)